

SMT Power Inductor

HCB0770A Type

Features

- RoHS compliant.
- Low profile, SMD type.
- High current.
- Magnetic shielded.
- High energy storage and low DCR.
- Provided with embossed carrier tape packing.
- Ideal for power source circuits, DC-DC converter, DC-AC inverters inductor applications.
- In addition to the standard versions shown here, customized inductors are available to meet your exact requirements.

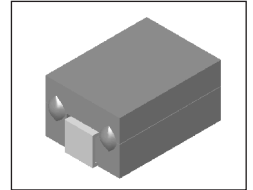

Mechanical Dimension :

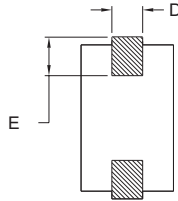
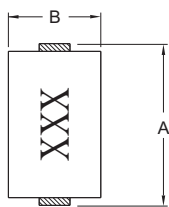

RECOMMENDED PAD PATTERNS

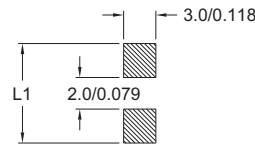

UNIT : mm/inch
 B = 7.00 / 0.276 Max.
 D = 2.50 / 0.098
 E = 1.50 / 0.059

Electrical Characteristics : At 25°C: 100KHz, 1V

PART NO.	L ¹ (nH)	Li (nH)	DCR (mΩ)	I _{sat} ² (Adc)	I _{rms} ³ (Adc)	A (mm/inch) MAX	C (mm/inch)	L1 (mm/inch)
HCB0770A-101	100	80	0.71 ± 20%	60	33	7.0 / 0.276	7.0 / 0.276	7.5 / 0.295
HCB0770A-101L	100	80	0.35 ± 20%	60	48	7.5 / 0.295	7.2 / 0.283	8.0 / 0.315
HCB0770A-151	150	120	0.71 ± 20%	44	33	7.0 / 0.276	7.0 / 0.276	7.5 / 0.295

1. Tolerance of inductance is ± 20%.
2. Isat is the DC current which cause the inductance drop not lower than Li.
3. Irms is the DC current which cause the surface temperature of the part increase less than 45°C.
4. Operating temperature : -20°C to 105°C (including self-temperature rise).



DELTA ELECTRONICS, INC.

(TAOYUAN PLANT CPBG) 252, SAN YING ROAD, KUEISAN INDUSTRIAL ZONE, TAOYUAN SHIEN, 333, TAIWAN, R.O.C.

TEL: 886-3-3591968; FAX: 886-3-3591991

<http://www.deltaww.com>